



ESCALATORS AND MOVING WALKWAYS  
**ESCALATORS**

**MP|SIERRA**

MP SIERRA 302, MP SIERRA 303, MP SIERRA 352,  
MP SIERRA 233, MP SIERRA 234, MP SIERRA 273,  
MP SIERRA 274, MP SIERRA 303, MP SIERRA 304

Escalators for metro stations, train stations and the like.

One step further in adaptability

	MP SIERRA 302	MP SIERRA 303	MP SIERRA 352	MP SIERRA 233	MP SIERRA 234	MP SIERRA 273	MP SIERRA 274	MP SIERRA 303	MP SIERRA 304
a	30°	30°	35°	23,2°	23,2°	27,3°	27,3°	30°	30°
Upper radius	1500	1500	1500	2700	2700	2700	2700	2700	2700
AA	2231	2631	2266	2898	3298	2945	3345	2863	3263
BB	2598	2998	2682	3220	3620	3350	3750	3283	3683
CC	Hx1,732	Hx1,732	Hx1,428	Hx2,333	Hx2,333	Hx1,938	Hx1,938	Hx1,732	Hx1,732
DD	2370	2770	2505	2885	3285	3047	3447	3000	3400
EE	2815	3215	2780	3730	4130	3613	4013	3500	3900
FF	4530	4930	4420	5700	6100	5450	5850	5160	5560
JJ (V)	870	870	850	919	919	900	900	870	870
JJ (T)	870	870	850	901	901	882	882	870	870
MM	1060	1060	1080	1040	1040	1060	1060	1060	1060
KK	8000	8400	7200	10200	10600	9800	10200	8800	9220



A	REACTION (KN)	
	Without intermediate support	With one intermediate support
600	R1=4,05xL+16,3	R1=4,05xL2+14
	R2=4,05xL+8,5	R2=4,05xL1+7
800	R1=4,45xL+17	R1=4,45xL2+16
	R2=4,45xL+9,5	R2=4,45xL1+7,5
1000	R1=4,95xL+19,5	R1=4,95xL2+17,2
	R2=4,95xL+10,5	R2=4,95xL1+8,3
		R3=5,2xL+11,3

Notes:  
1. L, L1 y L2 are in meters  
2. L1 and L2 do not exceed 15 metres

VERTICAL BALUSTRADE					SLOPED BALUSTRADE				
A	B	C	D	E	A	B	C	D	E
600	910	1195	1270	1790	600	837	1195	1270	1790
800	1110	1395	1470	1990	800	1037	1395	1470	1990
1000	1310	1595	1670	2190	1000	1237	1595	1670	2190

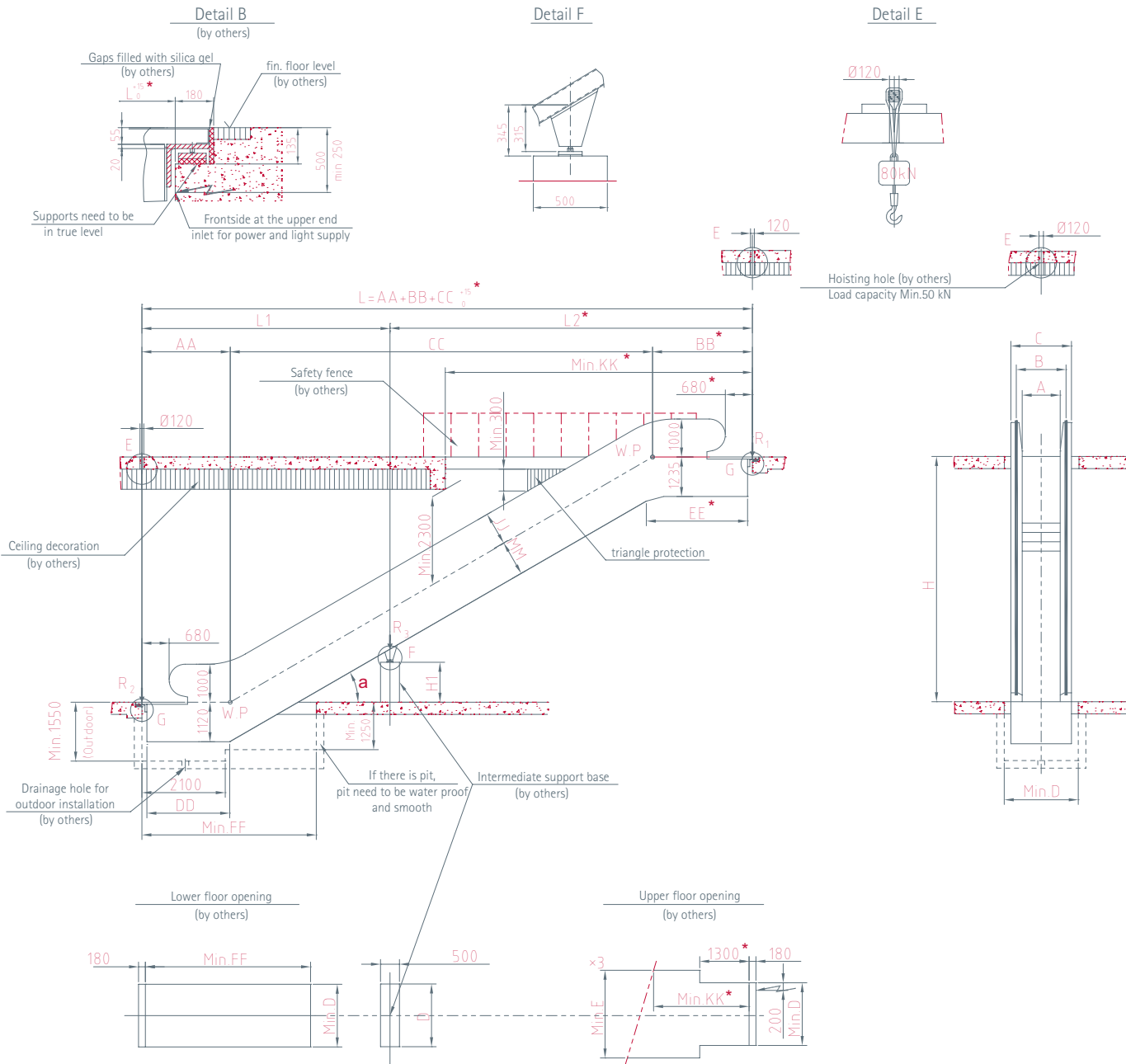

- NOTES:
1. Height above sea level of the escalator place should not be higher than 1000m. In case of doubt, please contact MP.
  2. If one of the following situations, the dimensions marked with \* shall be extended 500mm:  
 (1) 600 mm step width.  
 (2) Double drive.  
 (3) VVVF.  
 (4) 220V and power exceeds 7.5 kW.
  3. Client should provide the intermediate support base, which can be made of reinforced concrete or metallic structure in right position, in case of horizontal distance L higher than 15 m.
  4. The requirements of escalators and building interfaces must be according with the national standards (EN115-1:2008+A1:2010 ). In case of doubt, please contact MP.